



**Abbott**

# WORK IN-PERSON WITH COLLEAGUES AGAIN

## COVID-19 SELF-TESTING HELPS MAKE IT POSSIBLE

OUR RAPID TESTING TECHNOLOGY CAN HELP PEOPLE RETURN TO WORK.

Business owners and employees are ready for a new normal—one that allows them to restore operations with confidence and peace of mind.



# COVID-19 SELF-TESTING LETS US WORK.

FREQUENT, RAPID COVID-19 SELF-TESTING CAN HELP GIVE EMPLOYERS AND EMPLOYEES THE INFORMATION THEY NEED TO FEEL COMFORTABLE RETURNING TO WORK.

## PANBIO™ COVID-19 ANTIGEN SELF-TEST

- Simple, fast and reliable — easy even for people who have never tested themselves

Leverages technology and established performance of professional use test:

- Currently the only rapid antigen test with WHO emergency use listing for asymptomatic people
- Trusted brand used in more than 140 countries



# PERFORMANCE DATA ESTABLISHED WITH THE PROFESSIONAL USE PANBIO COVID-19 AG RAPID TEST DEVICE

## EXCELLENT TEST PERFORMANCE WITH COMFORTABLE NASAL SWAB

	SENSITIVITY	SPECIFICITY
PANBIO™ ANTIGEN TEST NASAL SWAB PERFORMANCE COMPARED TO NASAL PCR (N= 508)	98.1%	99.8%

## CONSUMER SELF-SWABBING IS ESSENTIALLY EQUIVALENT TO TRAINED HEALTHCARE PROFESSIONAL SWABBING

	SENSITIVITY	SPECIFICITY
PATIENT SUPERVISED SAMPLE COLLECTION COMPARED TO SAMPLE COLLECTED BY TRAINED PROFESSIONALS (N=287)	98.2%	100%

## PROVEN TO IDENTIFY INFECTED PEOPLE WITH NO SYMPTOMS

	SENSITIVITY*	SPECIFICITY
PANBIO™ ANTIGEN TEST NASAL PERFORMANCE IN POTENTIALLY INFECTIOUS ASYMPTOMATIC INDIVIDUALS COMPARED TO NASAL PCR (N= 483)	93.8%	100%

\*CT VALUES ≤ 30

## EASY TO USE, SIMPLE PROCEDURE WITH COMFORTABLE NASAL SWAB - INSERT ONLY 2CM INTO NOSE

### 1 PREPARE MATERIALS\*

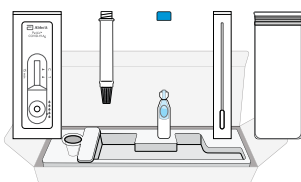

### 2 FILL TUBE



### 3 SWAB NOSE

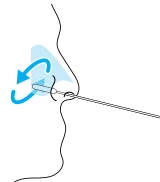

### 4 SWIRL SAMPLE



### 5 ADD 5 DROPS

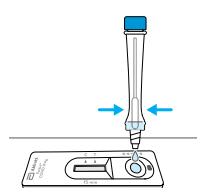

### 6 WAIT 15 MINUTES



### 7 READ RESULT



\*Kit components may vary

# THREE CONVENIENT KIT SIZES, WITH CLEAR INSTRUCTIONS FOR SELF-TESTING:

---

## 1 TEST PACK

CATALOG NUMBER:

41FK51

- 1 Test Device
- 1 Instructions for Use
- 1 Tube
- 1 Blue Cap
- 1 Buffer Bottle
- 1 Swab
- 1 Disposal Bag

KIT CONTENTS:



## 10 TEST PACK

CATALOG NUMBER:

41FK71

- 1 Instructions for Use
- 10 Test Devices
- 10 Tubes
- 10 Blue Caps
- 10 Buffer Bottles
- 10 Swabs
- 10 Disposal Bags
- 1 Tube Rack

KIT CONTENTS:



## 20 TEST PACK

CATALOG NUMBER:

41FK81

- 1 Instructions for Use
- 20 Test Devices
- 20 Tubes
- 20 Blue Caps
- 20 Buffer Bottles
- 20 Swabs
- 20 Disposal Bags
- 2 Tube Racks

KIT CONTENTS:



CONTACT YOUR LOCAL REPRESENTATIVE TODAY.

[WWW.GLOBALPOINTOF CARE.ABBOTT](http://WWW.GLOBALPOINTOF CARE.ABBOTT)

Product not available in all countries. Not approved for sale in the USA.

© 2021 Abbott. All rights reserved. All trademarks referenced are trademarks of either the Abbott group of companies or their respective owners. Any photos displayed are for illustrative purposes only. 120008421-01 04/21

